

SOLENOID VALVES PIV ON BASE

- PIV.I - PIV.T and PIV.B solenoid valves
- Assembly on base
- Bistable manual actuation
- Normally closed/normally open solenoid valves 2/2 – 3/2
- Installation in any position
- Particularly suitable for high operating frequencies and low response times



TECHNICAL DATA	PIV.I ON BASE	PIV.T ON BASE	PIV.B ON BASE
Absorption	5W - 5VA	3.8W - 6.5VA	10W - 13VA
Voltage available	12-24 VDC / 24-110-220 VAC	24VDC / 24-110-220 VAC	24VDC / 24-110-220 VAC
	50/60 Hz	50/60 Hz	50/60 Hz
Voltage tolerance	% -10 to +15	% -10 to +15	% -10 to +15
Max operating frequency	Hz 30	Hz 30	Hz 15
Solenoid rating	% 100	% 100	% 100
Response time	ms 8 to 15	ms 8 to 15	ms 10 to 15
Type of protection	IP 65	IP 65	IP 65
Type of coil	Coil side 22 Ø 8 DIN 43650	Coil side 22 Ø 9 DIN 43650	Coil side 30 DIN 43650
Insulation class	155	155	155
Ambient temperature	°C -15 to 50	°C -15 to 50	°C -15 to 50
Fluid temperature	°C -15 to 50	°C -15 to 50	°C -15 to 50
Fluid	Filtered lubricated or unlubricated air 25 million cycles	Filtered lubricated or unlubricated air 25 million cycles	Filtered lubricated or unlubricated air
Working life			-
Weight	g 80 to 120 (according to the version)	g 85	g 250
Maximum coil nut torque	Nm 1	Nm 1	Nm 1

COMPONENTS

- ① Manual control: technopolymer
- ② Body: technopolymer
- ③ Sleeve locking plate
- ④ Spring: stainless steel
- ⑤ Sleeve: brass OT 58
- ⑥ Ring nut for coil fixing
- ⑦ Gasket: NBR
- ⑧ Mobile core
- ⑨ Spring: stainless steel
- ⑩ Spring: stainless steel
- ⑪ Gasket: NBR

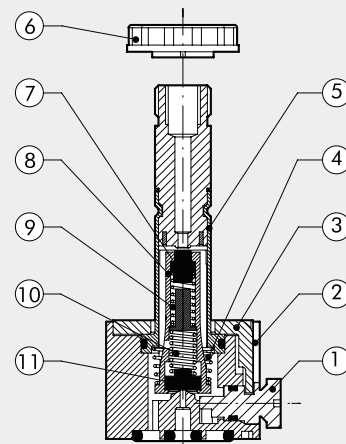

COILS, SIDE 22 mm FOR PIV.I SOLENOID VALVES, OPERATOR Ø 8

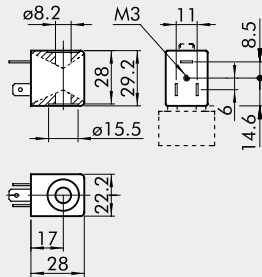

- Voltage tolerance: -10 to +15%
- Insulation class: F155
- Degree of protection: IP65 – EN60529 with connector
- Avoid prolonged exposure to the atmospheric agents.
- Maximum coil temperature at 100% use: 70°C at 20° ambient temperature
- According to Atex 2014/34/EU rule, group 2, category 3 GD

Code	Abbrev.	Nominal voltage	Absorption	
			Inrush	Holding
W0215000051	Coil 22 Ø 8 5W-12VDC	12Vcc	5W	5W
W0215000001	Coil 22 Ø 8 5W-24VDC	24Vcc	5W	5W
W0215000011	Coil 22 Ø 8 5VA-24VAC	24V 50/60Hz	8VA	5VA
W0215000021	Coil 22 Ø 8 5VA-110VAC	110V 50/60Hz	8VA	5VA
W0215000031	Coil 22 Ø 8 5VA-220VAC	220V 50/60Hz	8VA	5VA