

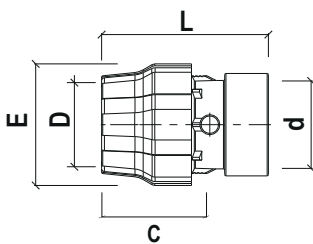

QLMPMAL		Nipple Socket - Aluminium body - female threaded				
Code	Gr.	D	d	L	E	C
QLMPMAL020048	44	20	1/2"	55	38	37
QLMPMAL020068	45	20	3/4"	55	38	37
QLMPMAL025068	68	25	3/4"	60	45	45
QLMPMAL025088	70	25	1"	60	45	45
QLMPMAL032108	157	32	1.1/4"	81	56	56
QLMPMAL040128	335	40	1.1/2"	94	62	77
QLMPMAL050168	468	50	2"	106	81	75
QLMPMAL063208	582	63	2.1/2"	134	97	95



Legend

α	Angular
C	Socket depth
C1	Socket depth 1
D	Socket diameter
D1	Socket diameter 1
Dp	Hollow mill driving diameter
Dpt	Largeness
d	Thread diameter
d1	Thread diameter 1
d2	Thread diameter 2
d3	Thread diameter 3
E	Overall outside diameter ring nut
E1	Overall outside diameter ring nut 1
Gr	Weight in grams
H	Height
On	holes number
L	Length
L1	Length 1
L2	Length 2
L Axial	Axial Length / Wheelbase
I	Misalignment
I1	Misalignment 1
r	Curvature radius (max)