

Equal Tee
Type FI-T ▪ Series LL / L / S

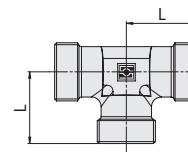
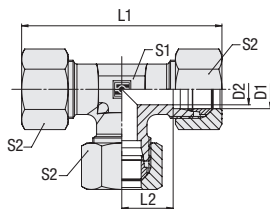

D

Ordering Codes

***FI-T*-10*L*-W3*-MS**

- * Equal Tee **FI-T**
- * Outside Tube Diameter D1 (in mm) **-10**
- * Series **LL**
 Extra-Light Series **L**
 Light Series **S**
 Heavy Series
- * Material Code **-W3**
 Steel, zinc/nickel-plated
- Please contact STAUFF for alternative materials and surface finishings.
- * Assembling / Kitting **—**
 Fitting body only
- Fitting body supplied with cutting rings and union nuts **-MS**
- Fitting body supplied with soft-sealing cutting rings and union nuts **-MSV**

Connecting Parts

- Cutting Ring
Type **FI-DS** Page 28
- Soft-Sealing Cutting Ring
Type **FI-WDDS** Page 29
- Support Sleeve
Type **FI-VH** Page 31
- STAUFF Form EVO Sealing Ring
Type **FI-FD** Page 32
- Union Nut
Type **FI-M** Page 33
- 37° Flared Tube Fitting Set
Type **FI-AB** Page 37

Series	Tube OD	PN	Dimensions					Weight (kg/lbs) ca. per 100	Ordering Codes ³		
	(mm/in) D1		(bar/psi)	(mm/in) D2	L	L1 ¹	L2			S1	S2
LL	4	100	3	15	42	11	9	10	1,00	FI-T-04LL-W3	
	.16	1450	.12	.59	1.65	.43	.35	.39	2.20	FI-T-06LL-W3	
	6	100	4,5	15	42	9,5	9	12	1,23	FI-T-06LL-W3	
	.24	1450	.18	.59	1.65	.37	.35	.47	2.70	FI-T-08LL-W3	
	8	100	6	17	46	11,5	12	14	1,91	FI-T-08LL-W3	
	.31	1450	.24	.67	1.81	.45	.47	.55	4.19	FI-T-10LL-W3	
	10	100	8	21,5	54	16	14	17	3,42	FI-T-10LL-W3	
	.39	1450	.31	.85	2.13	.63	.55	.67	7.54	FI-T-12LL-W3	
	12	100	10	21,5	59	15	14	19	3,80	FI-T-12LL-W3	
	.47	1450	.39	.85	2.32	.59	.55	.75	8.38	FI-T-12LL-W3	
	L	6	500	4	19	54	12	12	14	2,66	FI-T-06L-W3
		.24	7250	.16	.75	2.13	.47	.47	.55	5.86	FI-T-06L-W3
8		500	6	21	58	14	12	17	3,17	FI-T-08L-W3	
.31		7250	.24	.83	2.28	.55	.47	.67	6.97	FI-T-08L-W3	
10		500	8	22	60	15	14	19	4,06	FI-T-10L-W3	
.39		7250	.31	.87	2.36	.59	.55	.75	8.93	FI-T-10L-W3	
12		400	10	24	64	17	17	22	5,52	FI-T-12L-W3	
.47		5800	.39	.94	2.52	.67	.67	.87	12.15	FI-T-12L-W3	
15		400	12	28	72	21	19	27	9,98	FI-T-15L-W3	
.59		5800	.47	1.10	2.83	.83	.75	1.06	21.95	FI-T-15L-W3	
18		400	15	31	80	23,5	24	32	14,83	FI-T-18L-W3	
.71		5800	.59	1.22	3.15	.93	.94	1.26	32.63	FI-T-18L-W3	
22		250	19	35	88	27,5	27	36	18,81	FI-T-22L-W3	
.87		3625	.75	1.38	3.46	1.08	1.06	1.42	41.39	FI-T-22L-W3	
28		250	24	38	94	30,5	36	41	30,44	FI-T-28L-W3	
1.10		3625	.94	1.50	3.70	1.20	1.42	1.61	66.97	FI-T-28L-W3	
35		250	30	45	112	34,5	41	50	49,27	FI-T-35L-W3	
1.38		3625	1.18	1.77	4.41	1.36	1.61	1.97	108.39	FI-T-35L-W3	
42	250	36	51	126	40	50	60	72,20	FI-T-42L-W3		
1.65	3625	1.42	2.01	4.96	1.57	1.97	2.36	158.84	FI-T-42L-W3		
S	6	800	4	23	62	16	12	17	4,60	FI-T-06S-W3	
	.24	11600	.16	.91	2.44	.63	.47	.67	10.12	FI-T-06S-W3	
	8	800	5	24	64	17	14	19	6,21	FI-T-08S-W3	
	.31	11600	.20	.94	2.52	.67	.55	.75	13.65	FI-T-08S-W3	
	10	800	7	25	68	17,5	17	22	7,92	FI-T-10S-W3	
	.39	11600	.28	.98	2.68	.69	.67	.87	17.42	FI-T-10S-W3	
	12	630	8	29	76	21,5	17	24	10,88	FI-T-12S-W3	
	.47	9135	.31	1.14	2.99	.85	.67	.94	23.93	FI-T-12S-W3	
	14	630	10	30	80	22	19	27	12,97	FI-T-14S-W3	
	.55	9135	.39	1.18	3.15	.87	.75	1.06	28.53	FI-T-14S-W3	
	16	630	12	33	86	24,5	24	30	10,97	FI-T-16S-W3	
	.63	9135	.47	1.30	3.39	.96	.94	1.18	24.14	FI-T-16S-W3	
	20	420	16	37	96	26,5	27	36	25,58	FI-T-20S-W3	
	.79	6091	.63	1.46	3.78	1.04	1.06	1.42	56.28	FI-T-20S-W3	
	25	420	20	42	108	30	36	46	44,75	FI-T-25S-W3	
	.98	6091	.79	1.65	4.25	1.18	1.42	1.81	98.46	FI-T-25S-W3	
	30	420	25	49	124	35,5	41	50	68,20	FI-T-30S-W3	
	1.18	6091	.98	1.93	4.88	1.40	1.61	1.97	150.04	FI-T-30S-W3	
38	420	32	57	144	41	50	60	108,00	FI-T-38S-W3		
1.50	6091	1.26	2.24	5.67	1.61	1.97	2.36	237.60	FI-T-38S-W3		

¹ Approximate dimension in assembled condition.

² Weight excluding cutting rings and union nuts.

³ Standard scope of delivery: Fitting body only.

