

## VALVES SERIES 70, MECHANICALLY OPERATED, 1/8"

### TECHNICAL DATA

|                               |              |              |
|-------------------------------|--------------|--------------|
| Thread at valve ports         |              | 1/8"         |
| Operation force at 6 bar:     |              |              |
| • version with direct control | N            | 50           |
| • pilot-assisted version      | N            | 6            |
| Operating pressure:           |              |              |
| • version with direct control | bar          | Vacuum to 10 |
| • pilot-assisted version      | bar          | 2.5 to 10    |
| Operating temperature range   | °C           | -10 to +60   |
| Nominal diameter              | mm           | 5            |
| Conductance C                 | Nl/min · bar | 121.43       |
| Critical ratio b              | bar/bar      | 0.32         |
| Flow rate at 6 bar ΔP 0.5 bar | Nl/min       | 400          |
| Flow rate at 6 bar ΔP 1 bar   | Nl/min       | 550          |



### SYNOPTIC, SIZES AND VERSIONS

| M E V  |                              | 2          |      | 3        |     | T A          |                       | S              |                              | N C             |                 |
|--------|------------------------------|------------|------|----------|-----|--------------|-----------------------|----------------|------------------------------|-----------------|-----------------|
| FAMILY |                              | DIMENSIONS |      | FUNCTION |     | OPERATORS 14 |                       | RESETTING (12) |                              | FURTHER DETAILS |                 |
| MEV    | mechanically-operated valves | 2          | 1/8" | 3        | 3/2 | TA           | plunger               | S              | mechanical springs           | NC              | normally closed |
|        |                              |            |      | 5        | 5/2 | BR           | bidirectional roller  | A              | pneumatic/mechanical spring* | OO              | no indication   |
|        |                              |            |      |          |     | UR           | unidirectional roller |                |                              |                 |                 |
|        |                              |            |      |          |     | TS           | sensitive plunger     |                |                              |                 |                 |
|        |                              |            |      |          |     | RS           | sensitive roller      |                |                              |                 |                 |
|        |                              |            |      |          |     | AS           | sensitive aerial      |                |                              |                 |                 |
|        |                              |            |      |          |     | LL           | frontal roller lever  |                |                              |                 |                 |

### PLUNGER 3/2, 1/8"

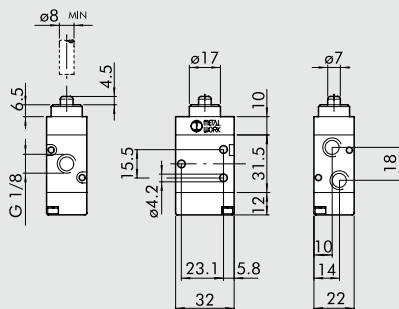

### PLUNGER 5/2, 1/8"

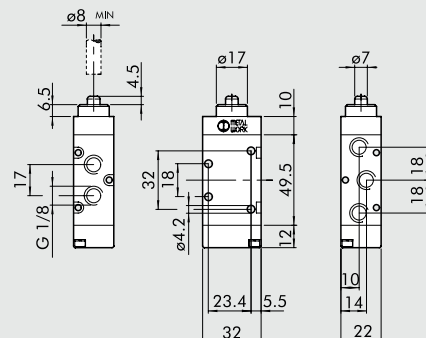

| Symbol | Code       | Abbrev.       | Weight [g] |
|--------|------------|---------------|------------|
|        | 7001000100 | MEV 23 TAS NC | 88         |

| Symbol | Code       | Abbrev.       | Weight [g] |
|--------|------------|---------------|------------|
|        | 7001000110 | MEV 25 TAS OO | 114        |