

Straight Male Stud Fitting
Type FI-GE-...-M-WD ▪ Series S

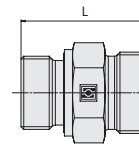
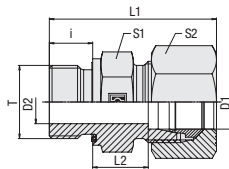

C

Ordering Codes

***FI-GE*-10*S*M*-WD*-B*-W3*-MS**

- * Straight Male Stud Fitting FI-GE
- * Outside Tube Diameter D1 (in mm) -10
- * Series L
Light Series (pages 52/53)
S
Heavy Series (page 54)
- * Thread Type M
Metric Parallel Thread
- If required, please indicate special sizes, e.g. M12x1.5!
- * Seal Type -WD
Profile Sealing Ring
- * Seal Material -B
NBR (Buna-N®)
-V
FKM (Viton®)
-E
EPDM
- * Material Code -W3
Steel, zinc/nickel-plated
- Please contact STAUFF for alternative materials and surface finishings.
- * Assembling / Kitting —
Fitting body only
- Fitting body supplied with cutting ring and union nut -MS
- Fitting body supplied with soft-sealing cutting ring and union nut -MSV

Connecting Parts

- Cutting Ring
Type FI-DS Page 28
- Soft-Sealing Cutting Ring
Type FI-WDDS Page 29
- Support Sleeve
Type FI-VH Page 31
- STAUFF Form EVO Sealing Ring
Type FI-FD Page 32
- Union Nut
Type FI-M Page 33
- 37° Flared Tube Fitting Set
Type FI-AB Page 37

Spare Parts / Accessories

- Profile Sealing Ring
Type WDG Page 238

Profile Sealing Ring

Metric Parallel Thread

Series	Tube OD (mm/in)	PN (bar/psi)	Dimensions (mm/in)										Torque (N-m/lbf-ft)	Weight (kg/lbs) ca. per 100	Ordering Codes ³
			Thread	T	D2	i	L	L1 ¹	L2	S1	S2	Thread T			
S	6	800	M 12 x 1,5	4	12	32	40	13	17	17	35	2,93	FI-GE-06SM-WD-B-W3		
	.24	11600		.16	.47	1.26	1.57	.51	.67	.67	25.9	6.44			
	8	800	M 12 x 1,5	4	12	34	41	14,5	19	19	35	3,18	FI-GE-08SM12x1.5-WD-B-W3		
	.31	11600		.16	.47	1.34	1.61	.57	.75	.75	25.9	7.01			
	8	800	M 14 x 1,5	5	12	34	42	15	19	19	55	4,16	FI-GE-08SM-WD-B-W3		
	.31	11600		.20	.47	1.34	1.65	.59	.75	.75	40.7	9.16			
	10	800	M 14 x 1,5	5	12	34,5	43,5	15	19	22	55	4,97	FI-GE-10SM14x1.5-WD-B-W3		
	.39	11600		.20	.47	1.36	1.71	.59	.75	.87	40.7	10.93			
	10	800	M 16 x 1,5	7	12	34,5	43,5	15	22	22	70	5,36	FI-GE-10SM-WD-B-W3		
	.39	11600		.28	.47	1.36	1.71	.59	.87	.87	51.8	11.79			
	12	800	M 14 x 1,5	5	12	36	45	16,5	22	24	55	6,00	FI-GE-12SM14x1.5-WD-B-W3		
	.47	11600		.20	.47	1.42	1.77	.65	.87	.94	40.7	13.20			
	12	800	M 16 x 1,5	8	12	36	45	16,5	22	24	70	6,12	FI-GE-12SM16x1.5-WD-B-W3		
	0,47	11600		.31	.47	1.42	1.77	.65	.87	.94	51.8	13.47			
	12	630	M 18 x 1,5	8	12	36,5	45,5	17	24	24	90	7,12	FI-GE-12SM-WD-B-W3		
	.47	9135		.31	.47	1.44	1.79	.67	.94	.94	66.6	15.67			
	12	630	M 22 x 1,5	8	14	39	48	17,5	27	24	135	9,28	FI-GE-12SM22x1.5-WD-B-W3		
	.47	9135		.31	.55	1.54	1.89	.69	1.06	.94	99.9	20.42			
	14	630	M 20 x 1,5	10	14	41	51	19	27	27	125	9,46	FI-GE-14SM-WD-B-W3		
	.55	9135		.39	.55	1.61	2.01	.75	1.06	1.06	92.5	20.82			
	16	630	M 18 x 1,5	8	12	38,5	48,5	18	24	30	90	7,82	FI-GE-16SM18x1.5-WD-B-W3		
	.63	9135		.31	.47	1.52	1.91	.71	.94	1.18	66.6	17.20			
	16	630	M 22 x 1,5	12	14	41	51	18,5	27	30	135	9,52	FI-GE-16SM-WD-B-W3		
	.63	9135		.47	.55	1.61	2.01	.73	1.06	1.18	99.9	20.95			
	16	420	M 27 x 2	12	16	43	53	18,5	32	30	180	14,46	FI-GE-16SM27x2-WD-B-W3		
	.63	6091		.47	.63	1.69	2.09	.73	1.26	1.18	133.2	31.88			
	20	420	M 22 x 1,5	12	14	45	56	20,5	32	36	135	14,03	FI-GE-20SM22x1.5-WD-B-W3		
	.79	6091		.47	.55	1.77	2.20	.81	1.26	1.42	99.9	30.93			
20	420	M 27 x 2	16	16	47	58	20,5	32	36	180	15,10	FI-GE-20SM-WD-B-W3			
.79	6091		.63	.63	1.85	2.28	.81	1.26	1.42	133.2	33.22				
25	420	M 26 x 1,5	15	16	51	62	23	41	46	180	24,27	FI-GE-25SM26x1.5-WD-B-W3			
.98	6091		.59	.63	2.01	2.44	.91	1.61	1.81	133.2	53.51				
25	420	M 27 x 2	16	16	51	62	23	41	46	180	24,42	FI-GE-25SM27x2-WD-B-W3			
.98	6091		.63	.63	2.01	2.44	.91	1.61	1.81	133.2	53.84				
25	420	M 33 x 2	20	18	53	65	23	41	46	310	26,43	FI-GE-25SM-WD-B-W3			
.98	6091		.79	.71	2.09	2.56	.91	1.61	1.81	229.4	58.15				
30	420	M 33 x 2	20	18	55	68	23,5	50	50	310	37,1	FI-GE-30SM33x2-WD-B-W3			
1.18	6091		.79	.71	2.17	2.68	.93	1.97	1.97	229.4	81.79				
30	420	M 42 x 2	25	20	57	70	23,5	50	50	450	41,84	FI-GE-30SM-WD-B-W3			
1.18	6091		.98	.79	2.24	2.76	.93	1.97	1.97	333.0	92.06				
38	420	M 48 x 2	32	22	64	79	26	55	60	540	57,00	FI-GE-38SM-WD-B-W3			
1.50	6091		1.26	.87	2.52	3.11	1.02	2.17	2.36	399.6	125.40				

¹ Approximate dimension in assembled condition.

² Weight excluding cutting ring and union nut.

³ Standard scope of delivery: Fitting body only.

Male stud acc. to ISO 9974-2 (Type E)

Port acc. to ISO 9974-1

Torque recommendations for Steel mating material.

Standard seal material is NBR (Buna-N®).

Male threaded studs were designed for female threaded ports in components made of steel. For applications with components made of softer mating materials (e.g. Aluminium), the use of connectors with additionally rolled male threads is recommended.

Please contact STAUFF prior to the assembly for further information.



Straight Male Stud Fitting
Type FI-GE-...-R-DF • Series L

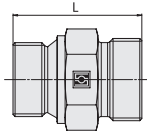
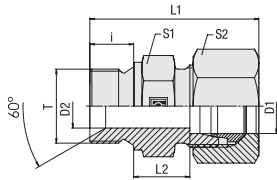

C

Whitworth Parallel Pipe Thread (BSPP)

60° Conical Bore / Sealing Surface for Gaskets

Series	Tube OD (mm/in)	PN (bar/psi)	Dimensions (mm/in)										Torque (N-m/lb-ft)	Weight (kg/lbs) ca. per 100	Ordering Codes ³
			D1	Thread	T	D2	i	L	L1 ¹	L2	S1	S2			
L	6	250	G 1/8	3,5	8	23,5	31,5	8,5	14	14	20	1,38	FI-GE-06LR-DF-W3		
	.24	3625		.14	.31	.93	1.24	.33	.55	.55	14.8	3.04			
6	250		G 1/4	4	12	29	36	10	19	14	50	2,75	FI-GE-06LR1/4-DF-W3		
	.24	3625		.16	.47	1.14	1.42	.39	.75	.55	37.0	6.05			
6	250		G 3/8	7,9	12	30,5	38	11	22	14	80	3,94	FI-GE-06LR3/8-DF-W3		
	.24	3625		.31	.47	1.20	1.50	.43	.87	.55	59.2	8.68			
8	250		G 1/8	3,5	8	24,5	32	10	14	17	20	1,71	FI-GE-08LR1/8-DF-W3		
	.31	3625		.14	.31	.96	1.26	.39	.55	.67	14.8	3.76			
8	250		G 1/4	4,7	12	29	37	10	19	17	50	2,87	FI-GE-08LR-DF-W3		
	.31	3625		.19	.47	1.14	1.46	.39	.75	.67	37.0	6.31			
8	250		G 3/8	6	12	30,5	38	11	22	17	80	4,28	FI-GE-08LR3/8-DF-W3		
	.31	3625		.24	.47	1.20	1.50	.43	.87	.67	59.2	9.41			
10	250		G 1/4	4,7	12	30	38	11	19	19	50	2,82	FI-GE-10LR-DF-W3		
	.39	3625		.19	.47	1.18	1.50	.43	.75	.75	37.0	6.21			
10	250		G 3/8	7,9	12	31,5	39	12,5	22	19	80	4,18	FI-GE-10LR3/8-DF-W3		
	.39	3625		.31	.47	1.24	1.54	.49	.87	.75	59.2	9.19			
10	160		G 1/2	11,1	14	34	41	13	27	19	140	6,28	FI-GE-10LR1/2-DF-W3		
	.39	2320		.44	.55	1.34	1.61	.51	1.06	.75	103.6	13.81			
12	250		G 1/4	4,7	12	31	39	12	19	22	50	3,30	FI-GE-12LR1/4-DF-W3		
	.47	3625		.19	.47	1.22	1.54	.47	.75	.87	37.0	7.26			
12	250		G 3/8	7,9	12	31,5	39,5	12,5	22	22	80	4,39	FI-GE-12LR-DF-W3		
	.47	3625		.31	.47	1.24	1.56	.49	.87	.87	59.2	9.66			
12	160		G 1/2	10	14	34	42	13	27	22	140	6,47	FI-GE-12LR1/2-DF-W3		
	.47	2320		.39	.55	1.34	1.65	.51	1.06	.87	103.6	14.23			
15	250		G 3/8	7,9	12	32,5	40	13,5	24	27	80	5,18	FI-GE-15LR3/8-DF-W3		
	.59	3625		.31	.47	1.28	1.57	.53	.94	1.06	59.2	11.39			
15	160		G 1/2	11,1	14	35	40,5	14	27	27	140	6,98	FI-GE-15LR-DF-W3		
	.59	2320		.44	.55	1.38	1.59	.55	1.06	1.06	103.6	15.35			
18	250		G 3/8	7,9	12	33,5	41	14	27	32	80	4,90	FI-GE-18LR3/8-DF-W3		
	.71	3625		.31	.47	1.32	1.61	.55	1.06	1.26	59.2	10.78			
18	160		G 1/2	11,1	14	35	45	13,5	27	32	140	5,35	FI-GE-18LR-DF-W3		
	.71	2320		.44	.55	1.38	1.77	.53	1.06	1.26	103.6	11.77			
18	160		G 3/4	15	16	38	47	14,5	32	32	190	10,79	FI-GE-18LR3/4-DF-W3		
	.71	2320		.59	.63	1.50	1.85	.57	1.26	1.26	140.6	23.74			
22	160		G 1/2	11,1	14	38	47	16,5	32	36	140	9,53	FI-GE-22LR1/2-DF-W3		
	.87	2320		.44	.55	1.50	1.85	.65	1.26	1.42	103.6	20.96			
22	160		G 3/4	16,7	16	40	49	16,5	32	36	190	9,94	FI-GE-22LR-DF-W3		
	.87	2320		.66	.63	1.57	1.93	.65	1.26	1.42	140.6	21.88			
22	160		G 1	22,2	18	43	51	17,5	41	36	330	16,58	FI-GE-22LR1-DF-W3		
	.87	2320		.87	.71	1.69	2.01	.69	1.61	1.42	244.2	36.48			
28	160		G 1/2	11,1	14	39	48	17,5	41	41	140	13,58	FI-GE-28LR1/2-DF-W3		
	1.10	2320		.44	.55	1.54	1.89	.69	1.61	1.61	103.6	29.88			
28	160		G 3/4	16,7	16	41	50	17,5	41	41	190	15,87	FI-GE-28LR3/4-DF-W3		
	1.10	2320		.66	.63	1.61	1.97	.69	1.61	1.61	140.6	34.91			
28	160		G 1	22,2	18	43	52	17,5	41	41	330	17,46	FI-GE-28LR-DF-W3		
	1.10	2320		.87	.71	1.69	2.05	.69	1.61	1.61	244.2	38.41			
28	160		G 1 1/4	28,6	20	48	57	20,5	50	41	540	20,04	FI-GE-28LR1-1/4-DF-W3		
	1.10	2320		1.13	.79	1.89	2.24	.81	1.97	1.61	399.6	44.09			
35	160		G 1	22,2	18	46	57	17,5	50	50	330	24,26	FI-GE-35LR1-DF-W3		
	1.38	2320		.87	.71	1.81	2.24	.69	1.97	1.97	244.2	53.37			
35	125		G 1 1/4	28,6	20	48	59	17,5	50	50	540	28,81	FI-GE-35LR-DF-W3		
	1.38	1813		1.13	.79	1.89	2.32	.69	1.97	1.97	399.6	63.37			
42	125		G 1 1/4	28,6	20	50	62	19	55	60	540	33,91	FI-GE-42LR1-1/4-DF-W3		
	1.65	1813		1.13	.79	1.97	2.44	.75	2.17	2.36	399.6	74.59			
42	125		G 1 1/2	33,3	22	52	64	19	55	60	630	36,75	FI-GE-42LR-DF-W3		
	1.65	1813		1.31	.87	2.05	2.52	.75	2.17	2.36	466.2	80.85			

Ordering Codes

FI-GE-10*L*R*-DF*-W3*-MS

* Straight Male Stud Fitting		FI-GE
* Outside Tube Diameter D1 (in mm)		-10
* Series	Light Series (page 55) Heavy Series (page 56)	L S
* Thread Type	Whitworth Parallel Pipe Thread (BSPP)	R
If required, please indicate special sizes, e.g. R1/8!		
* Seal Type	60° Conical Bore (BS 5200) / Sealing Surface for Gasket (DIN 7603)	-DF
* Material Code	Steel, zinc/nickel-plated	-W3
Please contact STAUFF for alternative materials and surface finishings.		
* Assembling / Kitting	Fitting body only	—
	Fitting body supplied with cutting ring and union nut	-MS
	Fitting body supplied with soft-sealing cutting ring and union nut	-MSV

Connecting Parts

	Cutting Ring Type FI-DS	Page 28
	Soft-Sealing Cutting Ring Type FI-WDDS	Page 29
	Support Sleeve Type FI-VH	Page 31
	STAUFF Form EVO Sealing Ring Type FI-FD	Page 32
	Union Nut Type FI-M	Page 33
	37° Flared Tube Fitting Set Type FI-AB	Page 37

Male threaded studs were designed for female threaded ports in components made of steel. For applications with components made of softer mating materials (e.g. Aluminium), the use of connectors with additionally rolled male threads is recommended. Please contact STAUFF prior to the assembly for further information.

¹ Approximate dimension in assembled condition.
² Weight excluding cutting ring and union nut.
³ Standard scope of delivery: Fitting body only.

Male stud acc. to DIN 3852-2 (Form A)
Port acc. to DIN 3852-2 (Form X) / ISO 1179-1

Torque recommendations for Steel mating material.

