

Straight Male Stud Fitting
Type FI-GE-...-R-WD ■ Series LL / L

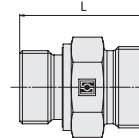
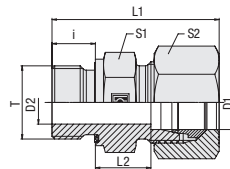

C

Ordering Codes

***FI-GE*-10*L*R*-WD*-B*-W3*-MS**

- * Straight Male Stud Fitting **FI-GE**
- * Outside Tube Diameter D1 (in mm) **-10**
- * Series Extra-Light Series (page 48) **LL**
 Light Series (pages 48/49) **L**
 Heavy Series (pages 50/51) **S**
- * Thread Type Whitworth Parallel Pipe Thread (BSPP) **R**
- If required, please indicate special sizes, e.g. R1/8!
- * Seal Type Profile Sealing Ring **-WD**
- * Seal Material NBR (Buna-N®) **-B**
 FKM (Viton®) **-V**
 EPDM **-E**
- * Material Code Steel, zinc/nickel-plated **-W3**
- Please contact STAUFF for alternative materials and surface finishings.
- * Assembling / Kitting Fitting body only **—**
- Fitting body supplied with cutting ring and union nut **-MS**
- Fitting body supplied with soft-sealing cutting ring and union nut **-MSV**

Connecting Parts

-  Cutting Ring
Type **FI-DS** Page 28
-  Soft-Sealing Cutting Ring
Type **FI-WDDS** Page 29
-  Support Sleeve
Type **FI-VH** Page 31
-  STAUFF Form EVO Sealing Ring
Type **FI-FD** Page 32
-  Union Nut
Type **FI-M** Page 33
-  37° Flared Tube Fitting Set
Type **FI-AB** Page 37

Spare Parts / Accessories

-  Profile Sealing Ring
Type **WDG** Page 238

Whitworth Parallel Pipe Thread (BSPP)

Profile Sealing Ring

Series	Tube OD		PN	Dimensions										Torque (N·m / ft·lb)	Weight (kg / lbs) ca.	Ordering Codes ³
	(mm/in)	D1		(bar/psi)	(mm/in)	Thread	T	D2	i	L	L1 ¹	L2	S1			
LL	6	100	100	G 1/8	4	8	21,5	28	8	14	12	18	1,14	13,3	2,51	FI-GE-06LLR-WD-B-W3
	.24	1450			.16	.31	.85	1.10	.31	.55	.47	13.3	2.51			
L	6	500	500	G 1/8	4	8	23,5	31,5	8,5	14	14	18	1,33	13,3	2,93	FI-GE-06LR-WD-B-W3
	.24	7250			.16	.31	.93	1.24	.33	.55	.55	13.3	2.93			
	6	500	500	G 1/4	4	12	29	37	10	19	14	35	2,74	25,9	6,04	FI-GE-06LR1/4-WD-B-W3
	.24	7250			.16	.47	1.14	1.46	.39	.75	.55	25.9	6.04			
	6	400	400	G 3/8	4	12	30,5	38,5	11,5	22	14	70	4,03	51,8	8,87	FI-GE-06LR3/8-WD-B-W3
	.24	5800			.16	.47	1.20	1.52	.45	.87	.55	51.8	8.87			
	6	400	400	G 1/2	4	14	33	41	12	27	14	90	6,37	66,6	14,01	FI-GE-06LR1/2-WD-B-W3
	.24	5800			.16	.55	1.30	1.61	.47	1.06	.55	66.6	14.01			
	8	500	500	G 1/8	4	8	24,5	32,5	9,5	14	17	18	1,61	13,3	3,53	FI-GE-08LR1/8-WD-B-W3
	.31	7250			.16	.31	.96	1.28	.37	.55	.67	13.3	3.53			
	8	500	500	G 1/4	6	12	29	37	10	19	17	35	2,65	25,9	5,83	FI-GE-08LR-WD-B-W3
	.31	7250			.24	.47	1.14	1.46	.39	.75	.67	25.9	5.83			
	8	400	400	G 3/8	6	12	30,5	38,5	11,5	22	17	70	4,35	51,8	9,57	FI-GE-08LR3/8-WD-B-W3
	.31	5800			.24	.47	1.20	1.52	.45	.87	.67	51.8	9.57			
	8	400	400	G 1/2	6	14	33	41	12	27	17	90	6,58	66,6	14,48	FI-GE-08LR1/2-WD-B-W3
	.31	5800			.24	.55	1.30	1.61	.47	1.06	.67	66.6	14.48			
	10	500	500	G 1/8	4	8	25,5	33,5	10,5	17	19	18	2,05	13,3	4,52	FI-GE-10LR1/8-WD-B-W3
	.39	7250			.16	.31	1.00	1.32	.41	.67	.75	13.3	4.52			
	10	500	500	G 1/4	6	12	30	38	11	19	19	35	2,88	25,9	6,34	FI-GE-10LR-WD-B-W3
	.39	7250			.24	.47	1.18	1.50	.43	.75	.75	25.9	6.34			
	10	500	500	G 3/8	8	12	31,5	39,5	12,5	22	19	70	4,15	51,8	9,12	FI-GE-10LR3/8-WD-B-W3
	.39	7250			.31	.47	1.24	1.56	.49	.87	.75	51.8	9.12			
	10	400	400	G 1/2	8	14	34	42	13	27	19	90	7,10	66,6	15,61	FI-GE-10LR1/2-WD-B-W3
	.39	5800			.31	.55	1.34	1.65	.51	1.06	.75	66.6	15.61			
	12	400	400	G 1/8	4	8	26,5	34,5	11,5	19	22	18	2,55	13,3	5,61	FI-GE-12LR1/8-WD-B-W3
	.47	5800			.16	.31	1.04	1.36	.45	.75	.87	13.3	5.61			
	12	400	400	G 1/4	6	12	31	39	12	19	22	35	3,05	25,9	6,70	FI-GE-12LR1/4-WD-B-W3
	.47	5800			.24	.47	1.22	1.54	.47	.75	.87	25.9	6.70			
	12	400	400	G 3/8	9	12	31,5	39,5	12,5	22	22	70	4,14	51,8	9,10	FI-GE-12LR-WD-B-W3
	.47	5800			.35	.47	1.24	1.56	.49	.87	.87	51.8	9.10			
	12	400	400	G 1/2	10	14	34	42	13	27	22	90	6,65	66,6	14,63	FI-GE-12LR1/2-WD-B-W3
	.47	5800			.39	.55	1.34	1.65	.51	1.06	.87	66.6	14.63			
	12	250	250	G 3/4	10	16	37	45	14	32	22	180	9,25	133,2	20,34	FI-GE-12LR3/4-WD-B-W3
	.47	3625			.39	.63	1.46	1.77	.55	1.26	.87	133.2	20.34			
	15	400	400	G 1/4	7	12	31,5	39,5	12,5	22	27	35	4,07	25,9	8,95	FI-GE-15LR1/4-WD-B-W3
	.59	5800			.28	.47	1.24	1.56	.49	.87	1.06	25.9	8.95			
	15	400	400	G 3/8	9	12	32,5	40,5	13,5	24	27	70	5,32	51,8	11,70	FI-GE-15LR3/8-WD-B-W3
	.59	5800			.35	.47	1.28	1.59	.53	.94	1.06	51.8	11.70			
	15	400	400	G 1/2	12	14	35	43	14	27	27	90	6,62	66,6	14,56	FI-GE-15LR-WD-B-W3
	.59	5800			.47	.55	1.38	1.69	.55	1.06	1.06	66.6	14.56			
	15	250	250	G 3/4	12	16	38	46	15	32	27	180	11,80	133,2	25,96	FI-GE-15LR3/4-WD-B-W3
	.59	3625			.47	.63	1.50	1.81	.59	1.26	1.06	133.2	25.96			
	15	250	250	G 1	12	18	42,5	49	17,5	41	27	310	22,61	229,4	49,85	FI-GE-15LR1-WD-B-W3
	.59	3625			.47	.71	1.67	1.93	.69	1.61	1.06	229.4	49.85			

¹ Approximate dimension in assembled condition.

² Weight excluding cutting ring and union nut.

³ Standard scope of delivery: Fitting body only.

Male stud acc. to ISO 1179-2 (Type E)

Port acc. to ISO 1179-1

Torque recommendations for Steel mating material.

Standard seal material is NBR (Buna-N®).

Male threaded studs were designed for female threaded ports in components made of steel. For applications with components made of softer mating materials (e.g. Aluminium), the use of connectors with additionally rolled male threads is recommended.

Please contact STAUFF prior to the assembly for further information.



Straight Male Stud Fitting
Type FI-GE-...-R-WD • Series L

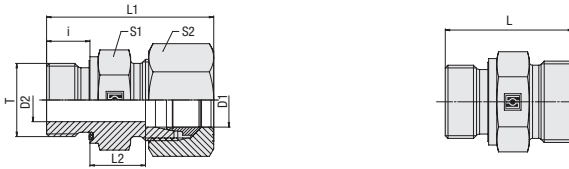

C

Profile Sealing Ring

Whitworth Parallel Pipe Thread (BSPP)

Series	Tube OD (mm/in)	PN (bar/PSI)	Dimensions (mm/in)										Torque (N•m/ft•lb)	Weight (kg/lbs) Ca. per 100	Ordering Codes ³
			Thread	T	D2	i	L	L ¹	L2	S1	S2	Thread T			
L	18	400	G 3/8	9	12	33,5	42,5	14	27	32	70	6,56	FI-GE-18LR3/8-WD-B-W3		
	.71	5800		.35	.47	1.32	1.67	.55	1.06	1.26	51.8	14.44			
	18	400	G 1/2	14	14	36	45	14,5	27	32	90	7,01	FI-GE-18LR-WD-B-W3		
	.71	5800		.55	.55	1.42	1.77	.57	1.06	1.26	66.6	15.41			
	18	400	G 3/4	15	16	38	47	14,5	32	32	180	10,89	FI-GE-18LR3/4-WD-B-W3		
	.71	5800		.59	.63	1.50	1.85	.57	1.26	1.26	133.2	23.96			
	18	250	G 1	22	18	43	48	17,5	41	32	310	18,44	FI-GE-18LR1-WD-B-W3		
	.71	3625		.87	.71	1.69	1.89	.69	1.61	1.26	229.4	40.65			
	22	250	G 1/2	14	14	38	47	16,5	32	36	90	8,75	FI-GE-22LR1/2-WD-B-W3		
	.87	3625		.55	.55	1.50	1.85	.65	1.26	1.42	66.6	19.25			
	22	250	G 3/4	18	16	40	49	16,5	32	36	180	10,28	FI-GE-22LR-WD-B-W3		
	.87	3625		.71	.63	1.57	1.93	.65	1.26	1.42	133.2	22.61			
	22	250	G 1	19	18	43	52	17,5	41	36	310	18,57	FI-GE-22LR1-WD-B-W3		
	.87	3625		.75	.71	1.69	2.05	.69	1.61	1.42	229.4	40.85			
	22	250	G 1 1/4	30	20	46	55	18,5	50	36	450	26,41	FI-GE-22LR1-1/4-WD-B-W3		
	.87	3625		1.18	.79	1.81	2.17	.73	1.97	1.42	333	58.22			
	28	250	G 3/4	18	16	41	50	17,5	41	41	180	14,97	FI-GE-28LR3/4-WD-B-W3		
	1.10	3625		.71	.63	1.61	1.97	.69	1.61	1.61	133.2	32.93			
	28	250	G 1	23	18	43	52	17,5	41	41	310	15,83	FI-GE-28LR-WD-B-W3		
	1.10	3625		.91	.71	1.69	2.05	.69	1.61	1.61	229.4	34.82			
	28	250	G 1 1/4	24	20	45	54	17,5	50	41	450	13,40	FI-GE-28LR1-1/4-WD-B-W3		
	1.10	3625		.94	.79	1.77	2.13	.69	1.97	1.61	333.0	29.48			
	35	250	G 3/4	18	16	44	55	17	46	50	180	20,71	FI-GE-35LR3/4-WD-B-W3		
	1.38	3625		.71	.63	1.73	2.17	.67	1.81	1.97	133.2	45.56			
	35	250	G 1	23	18	46	57	17,5	46	50	310	22,15	FI-GE-35LR1-WD-B-W3		
	1.38	3625		.91	.71	1.81	2.24	.69	1.81	1.97	229.4	48.74			
	35	250	G 1 1/4	30	20	48	59	17,5	50	50	450	27,23	FI-GE-35LR-WD-B-W3		
	1.38	3625		1.18	.79	1.89	2.32	.69	1.97	1.97	333.0	59.90			
	35	250	G 1 1/2	30	22	52	63	19,5	55	50	540	42,18	FI-GE-35LR1-1/2-WD-B-W3		
	1.38	3625		1.18	.87	2.05	2.48	.77	2.17	1.97	399.6	92.80			
	42	250	G 1	23	18	48	60	19	55	60	310	31,72	FI-GE-42LR1-WD-B-W3		
	1.65	3625		.91	.71	1.89	2.36	.75	2.17	2.36	229.4	69.78			
	42	250	G 1 1/4	30	20	50	62	19	55	60	450	34,03	FI-GE-42LR1-1/4-WD-B-W3		
	1.65	3625		1.18	.79	1.97	2.44	.75	2.17	2.36	333.0	74.87			
	42	250	G 1 1/2	36	22	52	64	19	55	60	540	34,37	FI-GE-42LR-WD-B-W3		
	1.65	3625		1.42	.87	2.05	2.52	.75	2.17	2.36	399.6	75.62			

¹ Approximate dimension in assembled condition.

² Weight excluding cutting ring and union nut.

³ Standard scope of delivery: Fitting body only.

Male stud acc. to ISO 1179-2 (Type E)

Port acc. to ISO 1179-1

Torque recommendations for Steel mating material.

Standard seal material is NBR (Buna-N®).

Male threaded studs were designed for female threaded ports in components made of steel. For applications with components made of softer mating materials (e.g. Aluminium), the use of connectors with additionally rolled male threads is recommended.

Please contact STAUFF prior to the assembly for further information.

Ordering Codes

***FI-GE*-10*L*R*-WD*-B*-W3*-MS**

- * Straight Male Stud Fitting FI-GE
- * Outside Tube Diameter D1 (in mm) -10
- * Series LL
L
S
Extra-Light Series (page 48)
Light Series (pages 48/49)
Heavy Series (pages 50/51)
- * Thread Type R
Whitworth Parallel
Pipe Thread (BSPP)
- If required, please indicate special sizes, e.g. R1/8!
- * Seal Type -WD
Profile Sealing Ring
- * Seal Material -B
-V
-E
NBR (Buna-N®)
FKM (Viton®)
EPDM
- * Material Code -W3
Steel, zinc/nickel-plated
- Please contact STAUFF for alternative materials and surface finishings.
- * Assembling / Kitting —
Fitting body only
Fitting body supplied with cutting ring and union nut -MS
Fitting body supplied with soft-sealing cutting ring and union nut -MSV

Connecting Parts

-  Cutting Ring
Type **FI-DS** Page 28
-  Soft-Sealing Cutting Ring
Type **FI-WDDS** Page 29
-  Support Sleeve
Type **FI-VH** Page 31
-  STAUFF Form EVO Sealing Ring
Type **FI-FD** Page 32
-  Union Nut
Type **FI-M** Page 33
-  37° Flared Tube Fitting Set
Type **FI-AB** Page 37

Spare Parts / Accessories

-  Profile Sealing Ring
Type **WDG** Page 238

