

## BXS SWAGED SKIVE FERRULE

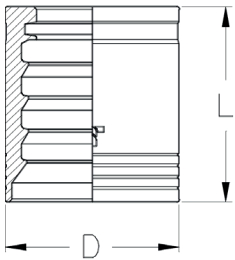

000000100  
10SAP1010  
101010000  
100011111

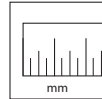
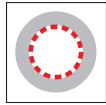
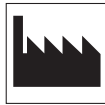

	CODE	DN	SIZE	INCH	D	L	APPLICATIONS
2020032834	BXS04	6	04	1/4"	22	30	4SP, R9R**
2020032835	BXS06	10	06	3/8"	26	32,5	4SP, R9R**, R12, 2ST, R2A
2020032836	BXS08	12	08	1/2"	30	35	4SP, R9R**, R12, 2ST, R2A
2020032837	BXS10	16	10	5/8"	34	38,5	4SP, R9R**, R12, 2ST, R2A
2020032830	BXS12	19	12	3/4"	38	43,5	4SP, R9R**, 4SH**, R12, 2ST, R2A
2020032838	BXS16	25	16	1"	46	54	4SP, R9R**, 4SH**, R12, 2ST, R2A
2020032839	BXS20	31	20	1.1/4"	56	61	4SP, R12, 2ST, R2A,
2020031981	BXS24	38	24	1.1/2"	65	68	4SP, R12, 2ST, R2A
2020032840	BXS32	51	32	2"	78	74	4SP



### WARNING

\*\* The application of **CX** series hose connectors must be limited to the **DIN856 4SP** maximum working pressure.