

# Newdeal REGULATOR



Highly reliable, heavy-duty piston-operated regulator.

- Stability of the set pressure as the upstream pressure varies
- Standard overpressure blowoff valve
- Can be fixed to the wall using the holes in the sides of the body.



TECHNICAL DATA		REG ND 1/4"	REG ND 3/8"	REG ND 1/2"	REG ND 3/4"	REG ND 1"
Threaded port		1/4"	3/8"	1/2"	3/4"	1"
Setting range	bar	0 to 4 - 0 to 8 - 0 to 12	0 to 4 - 0 to 8 - 0 to 12		0 to 4 - 0 to 8 - 0 to 12	
Max. inlet pressure	MPa	1.8	1.8		1.8	
	bar	18	18		18	
Flow rate at 6.3 bar (0.63 MPa to 91 psi) ΔP 0.5 bar (0.05 MPa to 7 psi)	Nl/min	200	1100		2500	
	scfm	7	39		89	
Flow rate at 6.3 bar (0.63 MPa to 91 psi) ΔP 1 bar (0.1 MPa to 14 psi)	Nl/min	650	2500		4500	
	scfm	23	89		160	
Max temperature at 1 MPa; 10 bar; 145 psi	°C	50	50		50	
	°F	122	122		122	
Weight	kg	0.3	0.8		1.5	
Wall fixing screws		M4 x 40	M4 x 55		M6 x 75	
Gauge port		1/8"	1/8"		1/4"	
Mounting position		In any position				
Fluid		Filtered, lubricated or unlubricated compressed air. Lubrication, if used, must be continuous.				
Note on use		The regulator pressure must always be set upwards. For increased sensitivity, use a pressure regulator with a rated pressure as close as possible to the required value. <b>Do not take off air from gauge ports.</b>				

## COMPONENTS

- ① Zamak body
- ② Technopolymer bell
- ③ Technopolymer knob
- ④ Technopolymer piston rod
- ⑤ Technopolymer plug
- ⑥ OT58 brass adjusting screw
- ⑦ OT58 brass nut
- ⑧ Ring nut : technopolymer (ND 1/4-3/8-1/2) brass (ND 3/4-1)
- ⑨ OT brass rod
- ⑩ Valve with NBR vulcanized gasket
- ⑪ NBR lip seal
- ⑫ NBR relieving seal
- ⑬ Steel adjusting spring
- ⑭ Steel valve compression spring
- ⑮ NBR gaskets

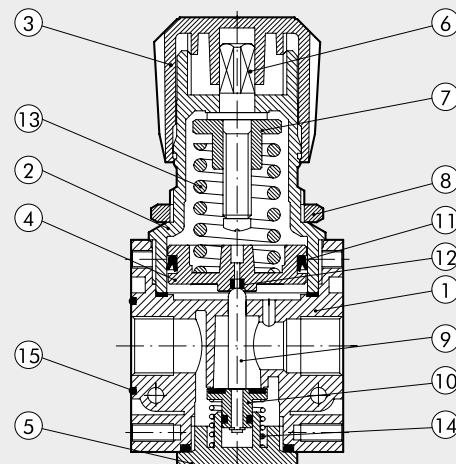

FLOW CHARTS

REG 1/4

$P_m = 0.7 \text{ MPa} - 7 \text{ bar} - 100 \text{ psi}$

Inlet pressure

psi MPa bar

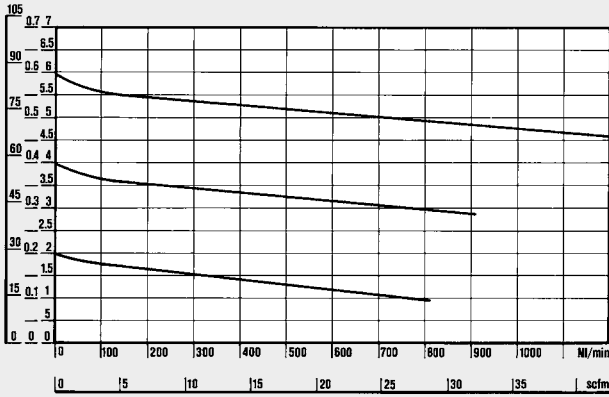

Department of Mechanics



Turin Polytechnic

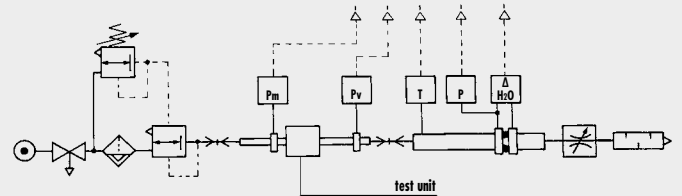

• Flow tests carried out at the Department of Mechanics, Turin Polytechnic, using the computerized test bench following CETOP RP50R recommendations (ISO DIS 6358-2-approved) with ISO 5167 diaphragm gauge.

REG 3/8 - 1/2

$P_m = 0.7 \text{ MPa} - 7 \text{ bar} - 100 \text{ psi}$

Inlet pressure

psi MPa bar

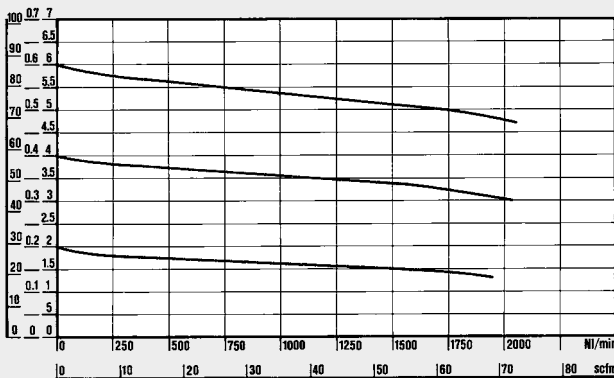

REG 3/4 - 1"

$P_m = 0.7 \text{ MPa} - 7 \text{ bar} - 100 \text{ psi}$

Inlet pressure

psi MPa bar

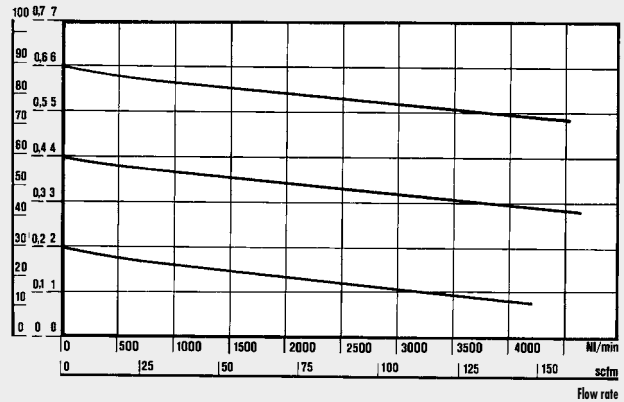

UNITS

New decl REGULATOR

DIMENSIONS

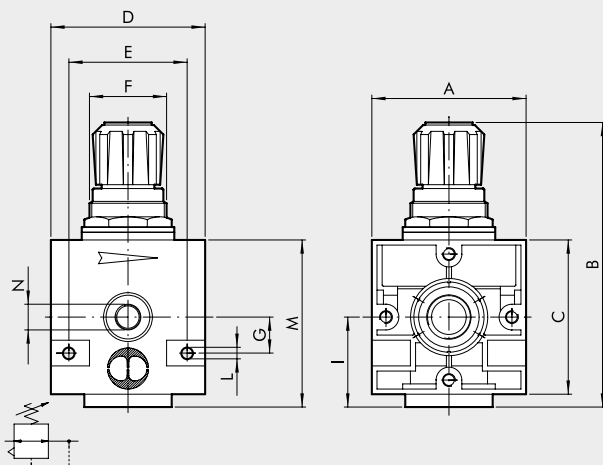

	REG ND 1/4"	REG ND 3/8"	REG ND 1/2"	REG ND 3/4"	REG ND 1"
Threaded port	1/4"	3/8"	1/2"	3/4"	1"
A	42	60		80	
B	94	130		184	
C	42	60		80	
D	42	60		80	
E	32	46		66	
F	30 x 1.5	38 x 2		55 x 2	
G	10	14		22	
I	25	35		47	
L	Hole for M4 screws	Hole for M4 screws		Hole for M6 screws	
M	49	70		94	
N (pressure gauge port)	1/8"	1/8"		1/4"	

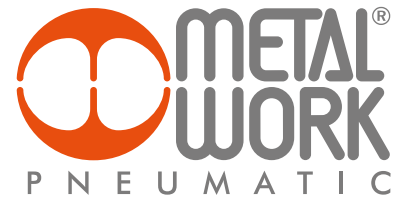

**SYNOPTIC, SIZES AND VERSIONS**

REG ELEMENT	1/4 THREADED PORT	04 SETTING RANGE
REG	1/4 3/8 1/2 3/4 1	04 = 0 to 4 bar 08 = 0 to 8 bar 012 = 0 to 12 bar

**ORDERING CODES**

Code	Description
<b>New deal</b>	<b>REGULATOR 1/4"</b>
1202001	REG 1/4 04
1202002	REG 1/4 08
1202003	REG 1/4 012
1202004	REG 1/4 02
<b>New deal</b>	<b>REGULATOR 3/8"</b>
1302001	REG 3/8 04
1302002	REG 3/8 08
1302003	REG 3/8 012
<b>New deal</b>	<b>REGULATOR 1/2"</b>
1402001	REG 1/2 04
1402002	REG 1/2 08
1402003	REG 1/2 012
<b>New deal</b>	<b>REGULATOR 3/4"</b>
1502001	REG 3/4 04
1502002	REG 3/4 08
1502003	REG 3/4 012
<b>New deal</b>	<b>REGULATOR 1"</b>
1602001	REG 1 04
1602002	REG 1 08
1602003	REG 1 012

**NOTES**

UNITS

New deal REGULATOR

# New deal PADLOCKABLE REGULATOR

The New deal padlockable regulator has a pin with a hole in it that projects from the top of the knob. When the knob is in the push-lock position, the padlock can be inserted in the hole, preventing the knob from being operated. A padlock and two keys are supplied with the regulator.

Refer to the regulator for technical data and flow curves.



## COMPONENTS

- ① Zamak body
- ② Technopolymer bell
- ③ Technopolymer knob
- ④ Technopolymer piston rod
- ⑤ Technopolymer plug
- ⑥ Nickel-plated brass OT58 adjusting screw
- ⑦ OT58 brass nut
- ⑧ Technopolymer ring nut
- ⑨ OT brass rod
- ⑩ Valve with NBR vulcanized gasket
- ⑪ NBR lip seal
- ⑫ NBR relieving seal
- ⑬ Steel adjusting spring
- ⑭ Steel valve compression spring
- ⑮ NBR gaskets
- ⑯ Padlock

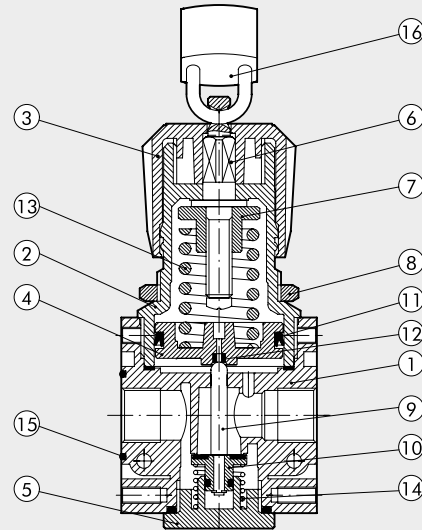

## DIMENSIONS

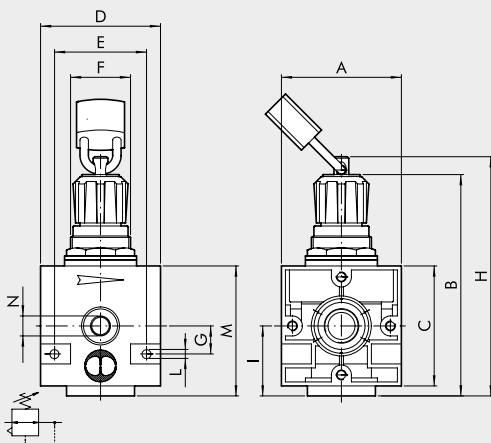

	REG KEY ND 1/4"	REG KEY ND 3/8"	REG KEY ND 1/2"
Threaded port	1/4"	3/8"	1/2"
A	42		60
B	90 to 94		126 to 130
C	42		60
D	42		60
E	32		46
F	30 x 1.5		38 x 2
G	10		14
H	96		131
I	25		35
L	Hole for M4 screws		Hole for M4 screws
M	49		70
N (pressure gauge port)	1/8"		1/8"

**SYNOPTIC, SIZES AND VERSIONS**

REG KEY ELEMENT	1/4 THREADED PORT	02 SETTING RANGE
REG KEY = padlockable regulator	1/4	02 = 0 to 2 bar
		04 = 0 to 4 bar
		08 = 0 to 8 bar
	3/8 1/2	012 = 0 to 12 bar
		04 = 0 to 4 bar
		08 = 0 to 8 bar
		012 = 0 to 12 bar

**ORDERING CODES**

Code	Description
<b>New deal PADLOCKABLE REGULATOR 1/4"</b>	
1210011	REG KEY 1/4 02
1210012	REG KEY 1/4 04
1210013	REG KEY 1/4 08
1210014	REG KEY 1/4 012
<b>New deal PADLOCKABLE REGULATOR 3/8"</b>	
1310012	REG KEY 3/8 04
1310013	REG KEY 3/8 08
1310014	REG KEY 3/8 012
<b>New deal PADLOCKABLE REGULATOR 1/2"</b>	
1410012	REG KEY 1/2 04
1410013	REG KEY 1/2 08
1410014	REG KEY 1/2 012

**NOTES**