

## Quick Line Fittings diam 20 ÷ 80 mm

QLMAAL	Coupling				
	Code	Gr.	D	L	E
QLMAAL020	64	20	77	38	37
QLMAAL025	100	25	95	45	45
QLMAAL032	233	32	120	56	56
QLMAAL040	283	40	156	62	77
QLMAAL050	590	50	165	81	75
QLMAAL063	966	63	193	97	95
QLMAAL080	1492	80	232	116	114

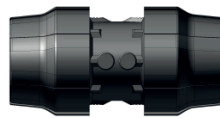

ALUMINUM

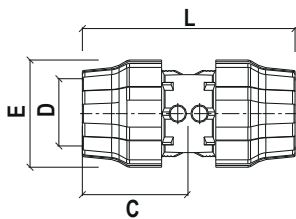

See video  
20 ÷ 80 mm



### Legend

$\alpha$	Angular
C	Socket depth
C1	Socket depth 1
D	Socket diameter
D1	Socket diameter 1
Dp	Hollow mill driving diameter
Dpt	Largeness
d	Thread diameter
d1	Thread diameter 1
d2	Thread diameter 2
d3	Thread diameter 3
E	Overall outside diameter ring nut
E1	Overall outside diameter ring nut 1
Gr	Weight in grams
H	Height
On	holes number
L	Length
L1	Length 1
L2	Length 2
L Axial	Axial Length / Wheelbase
I	Misalignment
I1	Misalignment 1
r	Curvature radius (max)