

Straight Male Stud Fitting
Type FI-GE-...-M-WD ▪ Series L

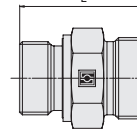
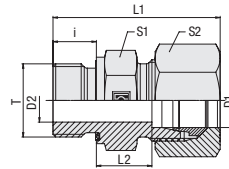

C

Ordering Codes

***FI-GE*-10*L*M*-WD*-B*-W3*-MS**

- * Straight Male Stud Fitting FI-GE
- * Outside Tube Diameter D1 (in mm) -10
- * Series L
Light Series (pages 52/53)
Heavy Series (page 54) S
- * Thread Type M
Metric Parallel Thread

If required, please indicate special sizes, e.g. M12x1.5!

- * Seal Type -WD
Profile Sealing Ring
- * Seal Material -B
NBR (Buna-N®)
-V
FKM (Viton®)
-E
EPDM
- * Material Code -W3
Steel, zinc/nickel-plated

Please contact STAUFF for alternative materials and surface finishings.

- * Assembling / Kitting —
Fitting body only
- Fitting body supplied with cutting ring and union nut -MS
- Fitting body supplied with soft-sealing cutting ring and union nut -MSV

Connecting Parts

- Cutting Ring
Type FI-DS Page 28
- Soft-Sealing Cutting Ring
Type FI-WDDS Page 29
- Support Sleeve
Type FI-VH Page 31
- STAUFF Form EVO Sealing Ring
Type FI-FD Page 32
- Union Nut
Type FI-M Page 33
- 37° Flared Tube Fitting Set
Type FI-AB Page 37

Spare Parts / Accessories

- Profile Sealing Ring
Type WDG Page 238

Metric Parallel Thread

Profile Sealing Ring

Series	Tube OD (mm/in)	PN (bar/psi)	Dimensions (mm/in)										Torque (N·m/ft·lb)	Weight (kg/lbs) Ca.	Ordering Codes ³
			Thread	T	D2	i	L	L1 ¹	L2	S1	S2	Thread T			
L	6	500	M 10 x 1	4	8	23,5	31,5	8,5	14	14	18	1,36	FI-GE-06LM-WD-B-W3		
				.24	7250	.16	.31	.93	1.24	.33	.55	.55		13.3	2.99
	6	500	M 12 x 1,5	4	12	29	37	10	17	14	25	2,26	FI-GE-06LM12x1.5-WD-B-W3		
				.24	7250	.16	.47	1.14	1.46	.39	.67	.55		18.5	4.98
	8	500	M 10 x 1	4	8	23,5	31,5	8,5	14	17	18	1,54	FI-GE-08LM10x1-WD-B-W3		
				.31	7250	.16	.31	.93	1.24	.33	.55	.67		13.3	3.39
	8	500	M 12 x 1,5	6	12	29	37	10	17	17	25	2,16	FI-GE-08LM-WD-B-W3		
				.31	7250	.24	.47	1.14	1.46	.39	.67	.67		18.5	4.75
	8	500	M 14 x 1,5	6	12	29	37	10	19	17	45	3,11	FI-GE-08LM14x1.5-WD-B-W3		
				.31	7250	.24	.47	1.14	1.46	.39	.75	.67		33.3	6.83
	8	400	M 16 x 1,5	6	12	30	38	11	22	17	55	4,05	FI-GE-08LM16x1.5-WD-B-W3		
				.31	5800	.24	.47	1.18	1.50	.43	.87	.67		40.7	8.91
	8	400	M 18 x 1,5	11	12	30,5	37	11,5	24	17	90	4,34	FI-GE-08LM18x1.5-WD-B-W3		
				.31	5800	.43	.47	1.20	1.46	.45	.94	.67		66.6	9.57
	8	400	M 22 x 1,5	14	14	34	41	13	27	17	125	7,66	FI-GE-08LM22x1.5-WD-B-W3		
				.31	5800	.55	.55	1.34	1.61	.51	1.06	.67		92.5	16.89
	10	500	M 10 x 1	4	8	25,5	33	10,5	17	19	18	2,14	FI-GE-10LM10x1-WD-B-W3		
				.39	7250	.16	.31	1.00	1.30	.41	.67	.75		13.3	4.72
	10	500	M 12 x 1,5	6	12	30	38	11	17	19	25	2,38	FI-GE-10LM12x1.5-WD-B-W3		
				.39	7251	.24	.47	1.18	1.50	.43	.67	.75		18.5	5.23
	10	500	M 14 x 1,5	7	12	30	38	11	19	19	45	2,88	FI-GE-10LM-WD-B-W3		
				.39	7251	.28	.47	1.18	1.50	.43	.75	.75		33.3	6.33
	10	500	M 16 x 1,5	8	12	31,5	39,5	12,5	22	19	55	4,05	FI-GE-10LM16x1.5-WD-B-W3		
				.39	7251	.31	.47	1.24	1.56	.49	.87	.75		40.7	8.91
10	500	M 18 x 1,5	8	12	31,5	39,5	12,5	24	19	90	4,94	FI-GE-10LM18x1.5-WD-B-W3			
			.39	7251	.31	.47	1.24	1.56	.49	.94	.75		66.6	10.86	
10	400	M 22 x 1,5	8	14	34	42	13	27	19	125	7,36	FI-GE-10LM22x1.5-WD-B-W3			
			.39	5800	.31	.55	1.34	1.65	.51	1.06	.75		92.5	16.19	
12	400	M 10 x 1	4	8	25,5	33	10,5	17	19	18	2,38	FI-GE-12LM10x1-WD-B-W3			
			.47	5800	.16	.31	1.00	1.30	.41	.67	.75		13.3	5.25	
12	400	M 12 x 1,5	4	12	32	40	11	19	22	25	2,84	FI-GE-12LM12x1.5-WD-B-W3			
			.47	5800	.16	.47	1.26	1.57	.43	.75	.87		18.5	6.25	
12	400	M 14 x 1,5	7	12	30	38	11	19	22	45	3,06	FI-GE-12LM14x1.5-WD-B-W3			
			.47	5800	.28	.47	1.18	1.50	.43	.75	.87		33.3	6.72	
12	400	M 16 x 1,5	9	12	31,5	39,5	12,5	22	22	55	3,94	FI-GE-12LM-WD-B-W3			
			.47	5800	.35	.47	1.24	1.56	.49	.87	.87		40.7	8.66	
12	400	M 18 x 1,5	10	12	31,5	39,5	12,5	24	22	90	4,90	FI-GE-12LM18x1.5-WD-B-W3			
			.47	5800	.39	.47	1.24	1.56	.49	.94	.87		66.6	10.78	
12	400	M 22 x 1,5	10	14	35	42	14	27	22	125	6,96	FI-GE-12LM22x1.5-WD-B-W3			
			.47	5800	.39	.55	1.38	1.65	.55	1.06	.87		92.5	15.31	
15	400	M 16 x 1,5	9	12	32,5	40,5	13,5	24	27	55	5,15	FI-GE-15LM16x1.5-WD-B-W3			
			.59	5800	.35	.47	1.28	1.59	.53	.94	1.06		40.7	11.33	
15	400	M 18 x 1,5	11	12	32,5	40,5	13,5	24	27	90	5,05	FI-GE-15LM-WD-B-W3			
			.59	5800	.43	.47	1.28	1.59	.53	.94	1.06		66.6	11.11	
15	400	M 22 x 1,5	12	14	35	43	14	27	27	125	7,15	FI-GE-15LM22x1.5-WD-B-W3			
			.59	5800	.47	.55	1.38	1.69	.55	1.06	1.06		92.5	15.73	
15	250	M 26 x 1,5	18	16	38	46	15	32	27	180	9,56	FI-GE-15LM26x1.5-WD-B-W3			
			.59	3625	.71	.63	1.50	1.81	.59	1.26	1.06		133.2	21.08	

¹ Approximate dimension in assembled condition.
² Weight excluding cutting ring and union nut.
³ Standard scope of delivery: Fitting body only.

Standard seal material is NBR (Buna-N®).

Male stud acc. to ISO 9974-2 (Type E)
 Port acc. to ISO 9974-1

Torque recommendations for Steel mating material.

Male threaded studs were designed for female threaded ports in components made of steel. For applications with components made of softer mating materials (e.g. Aluminium), the use of connectors with additionally rolled male threads is recommended.

Please contact STAUFF prior to the assembly for further information.

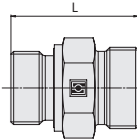
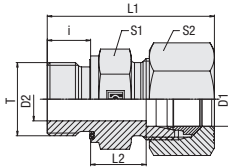

**Straight Male Stud Fitting
Type FI-GE-...-M-WD ▪ Series L**

C
Metric Parallel Thread
Profile Sealing Ring

Series	Tube OD (mm/in)	PN (bar/psi)	Dimensions (mm/in)								Torque (N·m/ft·lb)	Weight (kg/lbs) Ca. per 100	Ordering Codes ³
			D1	Thread	T	D2	i	L	L ¹	L ₂			
L	18	400	M 18 x 1,5	11	12	33,5	42,5	14	27	32	90	6,26	FI-GE-18LM18x1.5-WD-B-W3
	.71	5800		.43	.47	1.32	1.67	.55	1.06	1.26	66.6	13.77	
	18	400	M 22 x 1,5	14	14	36	45	14,5	27	32	125	7,43	FI-GE-18LM-WD-B-W3
	.71	5800		.55	.55	1.42	1.77	.57	1.06	1.26	92.5	16.35	
	18	250	M 26 x 1,5	15	16	38	47	16	32	32	180	10,88	FI-GE-18LM26x1.5-WD-B-W3
	.71	3625		.59	.63	1.50	1.85	.63	1.26	1.26	133.2	23.99	
	18	250	M 27 x 2	15	16	38	47	14,5	32	32	180	11,17	FI-GE-18LM27x2-WD-B-W3
	.71	3625		.59	.63	1.50	1.85	.57	1.26	1.26	133.2	24.63	
	18	250	M 33 x 2	15	18	41	49	15,5	41	32	310	13,17	FI-GE-18LM33x2-WD-B-W3
	.71	3625		.59	.71	1.61	1.93	.61	1.61	1.26	229.4	29.03	
	18	250	M 18 x 1,5	15	12	35,5	44	16	32	36	90	8,00	FI-GE-22LM18x1.5-WD-B-W3
	.71	3625		.59	.47	1.40	1.73	.63	1.26	1.42	66.6	17.64	
	22	250	M 22 x 1,5	14	14	38	47	16,5	32	36	125	9,10	FI-GE-22LM22x1.5-WD-B-W3
	.87	3625		.55	.55	1.50	1.85	.65	1.26	1.42	92.5	20.02	
	22	250	M 26 x 1,5	18	16	40	49	16,5	32	36	180	10,23	FI-GE-22LM-WD-B-W3
	.87	3625		.71	.63	1.57	1.93	.65	1.26	1.42	133.2	22.51	
	22	250	M 27 x 2	18	16	40	50	16,5	32	36	180	10,45	FI-GE-22LM27x2-WD-B-W3
	.87	3625		.71	.63	1.57	1.97	.65	1.26	1.42	133.2	23.04	
	22	250	M 33 x 2	23	18	43	52	17,5	41	36	310	16,15	FI-GE-22LM33x2-WD-B-W3
	.87	3625		.91	.71	1.69	2.05	.69	1.61	1.42	229.4	35.60	
	28	250	M 26 x 1,5	18	16	41	50	17,5	41	41	180	14,39	FI-GE-28LM26x1.5-WD-B-W3
	1.10	3625		.71	.63	1.61	1.97	.69	1.61	1.61	133.2	31.72	
	28	250	M 33 x 2	23	18	43	52	17,5	41	41	310	16,76	FI-GE-28LM-WD-B-W3
	1.10	3625		.91	.71	1.69	2.05	.69	1.61	1.61	229.4	36.87	
	28	250	M 42 x 2	30	20	46	55	18,5	50	41	450	26,5	FI-GE-28LM42x2-WD-B-W3
	1.10	3625		1.18	.79	1.81	2.17	.73	1.97	1.61	333.0	58.42	
	35	250	M 33 x 2	23	18	46	57	17,5	46	50	310	21,56	FI-GE-35LM33x2-WD-B-W3
	1.38	3625		.91	.71	1.81	2.24	.69	1.81	1.97	229.4	47.53	
	35	250	M 42 x 2	30	20	48	59	17,5	50	50	450	27,63	FI-GE-35LM-WD-B-W3
	1.38	3625		1.18	.79	1.89	2.32	.69	1.97	1.97	333.0	60.79	
	42	250	M 42 x 2	30	20	50	61	19	55	60	450	21,09	FI-GE-42LM42x2-WD-B-W3
	1.65	3625		1.18	.79	1.97	2.40	.75	2.17	2.36	333.0	46.50	
	42	250	M 48 x 2	36	22	52	64	19	55	60	540	34,63	FI-GE-42LM-WD-B-W3
	1.65	3625		1.42	.87	2.05	2.52	.75	2.17	2.36	399.6	76.19	

¹ Approximate dimension in assembled condition.

² Weight excluding cutting ring and union nut.

³ Standard scope of delivery: Fitting body only.

Standard seal material is NBR (Buna-N®).

Male stud acc. to ISO 9974-2 (Type E)

Port acc. to ISO 9974-1

Torque recommendations for Steel mating material.

Male threaded studs were designed for female threaded ports in components made of steel. For applications with components made of softer mating materials (e.g. Aluminium), the use of connectors with additionally rolled male threads is recommended.

Please contact STAUFF prior to the assembly for further information.

Ordering Codes
***FI-GE*-10*L*M*-WD*-B*-W3*-MS**

* Straight Male Stud Fitting	FI-GE
* Outside Tube Diameter D1 (in mm)	-10
* Series	Light Series (pages 52/53) L Heavy Series (page 54) S
* Thread Type	Metric Parallel Thread M
If required, please indicate special sizes, e.g. M12x1.5!	
* Seal Type	Profile Sealing Ring -WD
* Seal Material	NBR (Buna-N®) -B FKM (Viton®) -V EPDM -E
* Material Code	Steel, zinc/nickel-plated -W3

Please contact STAUFF for alternative materials and surface finishings.

* Assembling / Kitting	Fitting body only —
	Fitting body supplied with cutting ring and union nut -MS
	Fitting body supplied with soft-sealing cutting ring and union nut -MSV

Connecting Parts

	Cutting Ring Type FI-DS	Page 28
	Soft-Sealing Cutting Ring Type FI-WDDS	Page 29
	Support Sleeve Type FI-VH	Page 31
	STAUFF Form EVO Sealing Ring Type FI-FD	Page 32
	Union Nut Type FI-M	Page 33
	37° Flared Tube Fitting Set Type FI-AB	Page 37

Spare Parts / Accessories

	Profile Sealing Ring Type WDG	Page 238
--	---	----------

