

**Equal Cross**  
**Type FI-K • Series LL / L / S**

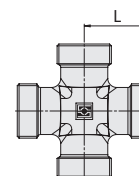
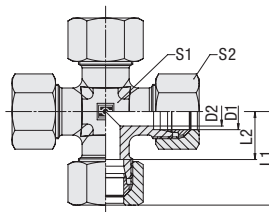

D

**Ordering Codes**

**\*FI-K\*-10\*L\*-W3\*-MS**

- \* Equal Cross **FI-K**
- \* Outside Tube Diameter D1 (in mm) **-10**
- \* Series **LL**  
 Extra-Light Series **L**  
 Light Series **S**  
 Heavy Series
- \* Material Code **-W3**  
 Steel, zinc/nickel-plated
- Please contact STAUFF for alternative materials and surface finishings.
- \* Assembling / Kitting **—**  
 Fitting body only
- MS**  
 Fitting body supplied with cutting rings and union nuts
- MSV**  
 Fitting body supplied with soft-sealing cutting rings and union nuts

**Connecting Parts**

- Cutting Ring  
Type **FI-DS** Page 28
- Soft-Sealing Cutting Ring  
Type **FI-WDDS** Page 29
- Support Sleeve  
Type **FI-VH** Page 31
- STAUFF Form EVO Sealing Ring  
Type **FI-FD** Page 32
- Union Nut  
Type **FI-M** Page 33
- 37° Flared Tube Fitting Set  
Type **FI-AB** Page 37

Series	Tube OD		Dimensions						Weight (kg/lbs) ca. per 100	Ordering Codes <sup>3</sup>
	(mm/in)	(bar/psi)	(mm/in)							
	D1		D2	L	L1 <sup>1</sup>	L2	S1	S2		
LL	4	100	3	15	21	11	9	10	1,68	FI-K-04LL-W3
	.16	1450	.12	.59	.83	.43	.35	.39	3,69	
	6	100	4,5	15	21	9,5	9	12	1,76	FI-K-06LL-W3
	.24	1450	.18	.59	.83	.37	.35	.47	3,87	
	8	100	6	17	23	11,5	12	14	2,85	FI-K-08LL-W3
L	.31	1450	.24	.67	.91	.45	.47	.55	6,27	
	6	500	4	19	27	12	12	14	3,40	FI-K-06L-W3
	.24	7250	.16	.75	1.06	.47	.47	.55	7,48	
	8	500	6	21	29	14	12	17	3,93	FI-K-08L-W3
	.31	7250	.24	.83	1.14	.55	.47	.67	8,64	
	10	500	8	22	30	15	14	19	5,01	FI-K-10L-W3
	.39	7250	.31	.87	1.18	.59	.55	.75	11,02	
	12	400	10	24	32	17	17	22	6,90	FI-K-12L-W3
	.47	5800	.39	.94	1.26	.67	.67	.87	15,19	
	15	400	12	28	36	21	19	27	12,36	FI-K-15L-W3
	.59	5800	.47	1.10	1.42	.83	.75	1.06	27,19	
	18	400	15	31	40	23,5	24	32	17,40	FI-K-18L-W3
	.71	5800	.59	1.22	1.57	.93	.94	1.26	38,28	
	22	250	19	35	44	27,5	27	36	22,60	FI-K-22L-W3
	.87	3625	.75	1.38	1.73	1.08	1.06	1.42	49,72	
	28	250	24	38	47	30,5	36	41	35,60	FI-K-28L-W3
	1.10	3625	.94	1.50	1.85	1.20	1.42	1.61	78,32	
	35	250	30	45	56	34,5	41	50	54,67	FI-K-35L-W3
1.38	3625	1.18	1.77	2.20	1.36	1.61	1.97	120,27		
42	250	36	51	63	40	50	60	92,70	FI-K-42L-W3	
1.65	3625	1.42	2.01	2.48	1.57	1.97	2.36	209,30		
S	6	800	4	23	31	16	12	17	5,79	FI-K-06S-W3
	.24	11600	.16	.91	1.22	.63	.47	.67	12,74	
	8	800	5	24	32	17	14	19	7,91	FI-K-08S-W3
	.31	11600	.20	.94	1.26	.67	.55	.75	17,41	
	10	800	7	25	34	17,5	17	22	10,13	FI-K-10S-W3
	.39	11600	.28	.98	1.34	.69	.67	.87	22,28	
	12	630	8	29	38	21,5	17	24	13,59	FI-K-12S-W3
	.47	9135	.31	1.14	1.50	.85	.67	.94	29,90	
	14	630	10	30	40	22	19	27	16,21	FI-K-14S-W3
	.55	9135	.39	1.18	1.57	.87	.75	1.06	35,65	
	16	630	12	33	43	24,5	24	30	22,15	FI-K-16S-W3
	.63	9135	.47	1.30	1.69	.96	.94	1.18	48,73	
	20	420	16	37	48	26,5	27	36	31,07	FI-K-20S-W3
	.79	6091	.63	1.46	1.89	1.04	1.06	1.42	68,35	
	25	420	20	42	54	30	36	46	53,00	FI-K-25S-W3
.98	6091	.79	1.65	2.13	1.18	1.42	1.81	116,60		
30	420	25	49	62	35,5	41	50	84,30	FI-K-30S-W3	
1.18	6091	.98	1.93	2.44	1.40	1.61	1.97	185,46		
38	420	32	57	72	41	50	60	135,10	FI-K-38S-W3	
1.50	6091	1.26	2.24	2.83	1.61	1.97	2.36	297,22		

<sup>1</sup> Approximate dimension in assembled condition.

<sup>2</sup> Weight excluding cutting rings and union nuts.

<sup>3</sup> Standard scope of delivery: Fitting body only.

